

RUDRA GRIHA

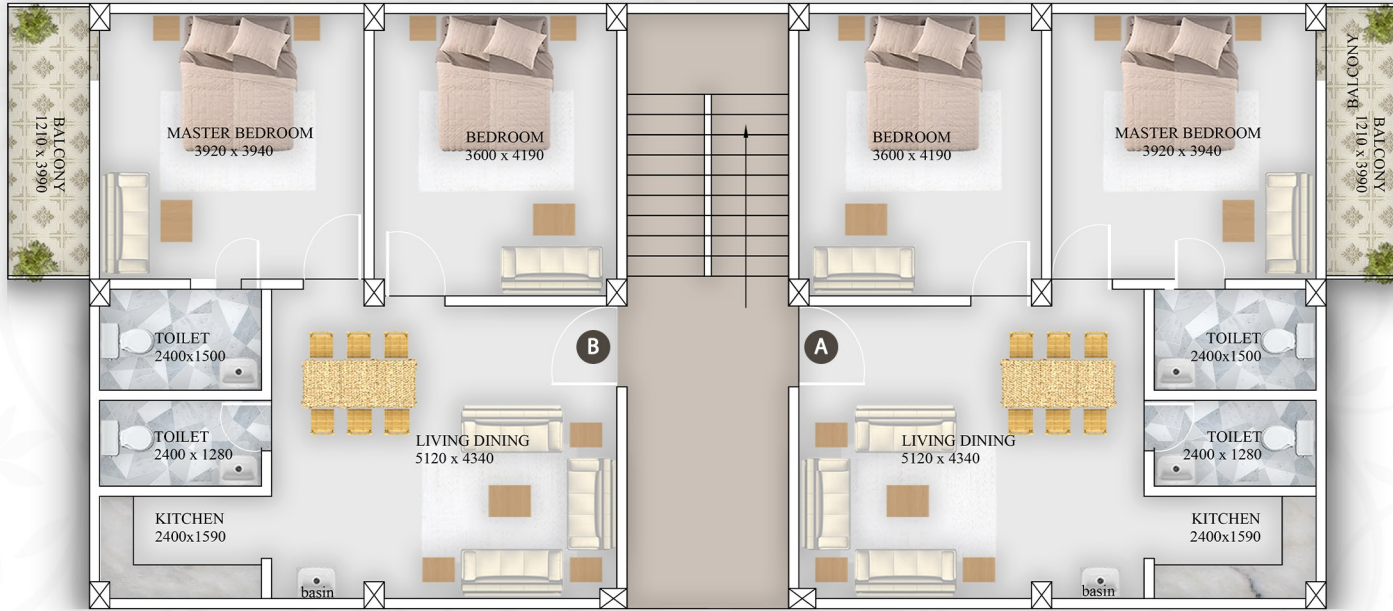

FLOOR PLANS



Ground floor plan

TYPE	BHK	CA	SBUA
Type - A	2BHK	824 sq.ft	1030 sq.ft
Type - B	2BHK	824 sq.ft	1030 sq.ft



1st & 2nd floor plan

TYPE	BHK	CA	SBUA
Type - A	3BHK	1013 sq.ft	1266 sq.ft
Type - B	3BHK	1061 sq.ft	1326 sq.ft



STRUCTURE

R.C.C. seismic resistant frame structure as per I.S. code of practice.

FLOORS

Vitrified flooring of size 600mmx600mm in drawing and dining rooms, bed room and kitchen. Antiskid ceramic tiles (300mmx300mm) in bathroom.

TOILET

Concealed CPVC plumbing and sanitary system. White color sanitary ware and good quality water supply fitting. Gazed wall tiles 7 ft on wall.

KITCHEN

Marble/Granite kitchen slab and wall tiles two feet above slab. Stainless steel sinks with good quality CP water supply fitting.

DOORS

Water proof flush door.

WINDOWS

Plain aluminum sliding windows with grill.

PAINTING

Internal walls to be finished with wallputty. External walls are to be painted with good quality cement paint as per builder's choice.

WATER SUPPLY

Deep tubewell with provision for water supply and individual 1000 Ltr. plastic tank.



PAYMENT TERMS

at the time of booking and agreement	20% + GST
at the time of foundation	20% + GST
1st slab casting	15% + GST
2nd slab casting	10% + GST
3rd slab casting	10% + GST
at the time of brick work and plaster	10% + GST
at the time of tiles fixing	10% + GST
before hand over	5% + GST

SITE LOCATION

Near Srinivasa Ramanujan Academy, By lane -3
Rupkonwar Path, Near Trinayan Shiv Mandir,
Jonaki Nagar, Pincode- 781040.

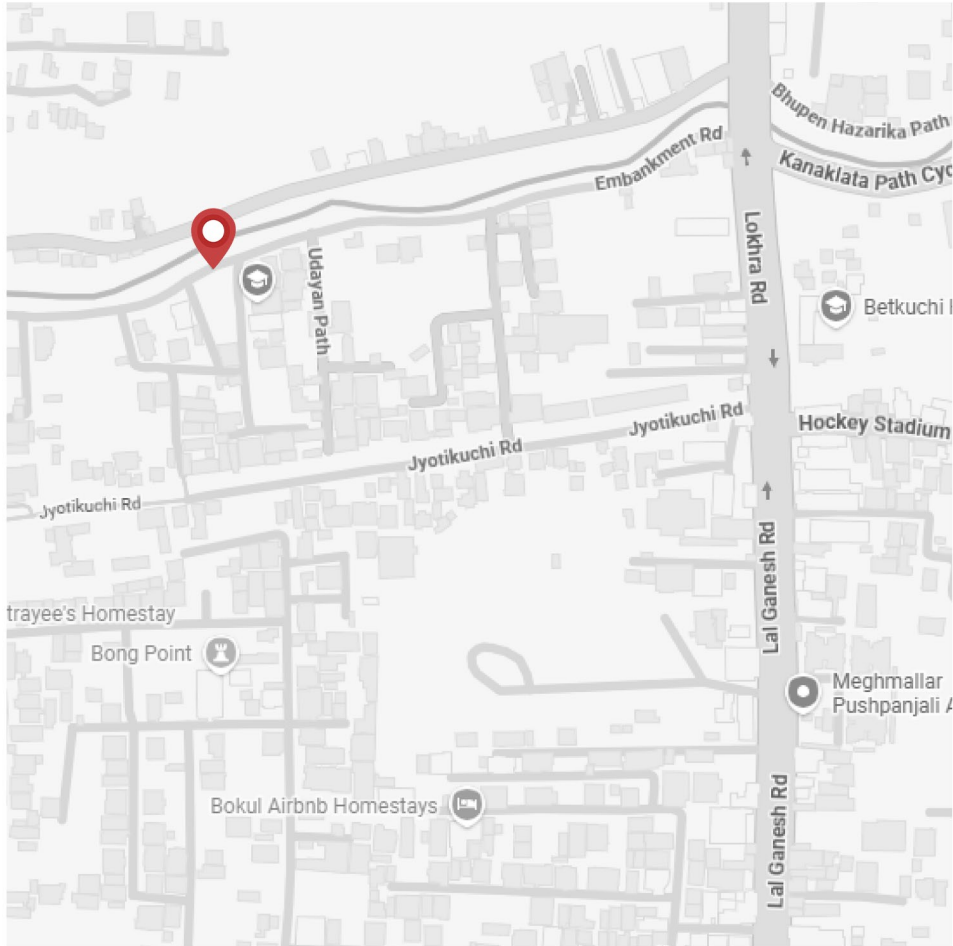

BUILDER

REAL DIMENSIONS CONSTRUCTION
Adabari, Guwahati.
+91 7002579289 +91 6001085018

3D & Graphics by **REENOV** | +91 887 649 3221

